



## Burden Museum & Gardens Welcome Center

by Dr. Jeff Kuehny

Have you ever gone to visit someone who you knew had a magnificent house but when you arrived there was no front door? Have you ever gotten to a destination you knew was filled with treasures, but you had no idea how to get to them? Have you ever stumbled upon a magical place and wondered how it came to be? That is what most visitors experience when they arrive at Burden Museum & Gardens.

With your support, you can help enhance the visitor experience to one of the most treasured places in Baton Rouge. The Burden Museum & Gardens Welcome Center will serve as the front door for friends and visitors with information on all the special places they can explore on their journey through the 440-acre property in the heart of Louisiana's capital city. It also will provide an overview of the rich history of the Burden family and the Burden property, which was one of the largest donations ever made to LSU.

The Burden family made this gift to the community as a unique and special place to discover and contemplate nature. It is a place to understand history through the Rural Life Museum and Windrush Gardens, conduct LSU- and LSU AgCenter-based research and educational programs for our state and our community, and to learn and reflect on hopes for the future. This facility will serve the community, the LSU AgCenter and the LSU A&M campus by increasing capacity for classes, small workshops, meetings, educational programs, receptions and celebrations.

The Welcome Center design, by local architects Eskew Dumez Ripple, provides a space to view a different Louisiana landscapes from each of the four sides: wetlands, woodlands and pastoral and designed landscapes. The roof of the Welcome Center is not your typical gabled roof but is designed so that all outer sides slope to the center so that

*continued on page 6*



## Reflections From the Chair

*Leigh Harris*

*Chair, Friends of LSU AgCenter Botanic Gardens*

**Friends of  
LSU AgCenter  
Botanic Gardens  
at Burden**

### **Board Members**

Dr. Jeff Kuehny

*Ex-Officio Director*

Len Kilgore

*Liaison, Burden Foundation*

Dr. Wade Baumgartner

*Liaison, LSU AgCenter*

Leigh Harris

*Chair*

Leo Broders

*Treasurer*

### **Directors:**

Ken Bosso

Janie Braud

Scott Courtright

Elena Fennell

Richard Gibbs

Dr. Charlie Johnson

Simone Kramer

Kevin Langley

Julie McCarthy

Kathleen Meares

Danielle Mensman

Jim Morrison

Cynthia Nobles

Richard Oliver

Namisha Patel-Vasanji

Claudia Ross

Randy Roussel

Mary Tauzin

Mary Tharp

Diana Wells

Kitty Hessburg Wiemer

Paul Woodward

The newsletter is a quarterly publication of the Friends of LSU AgCenter Botanic Gardens at Burden, which is part of Burden Museum & Gardens.

**LSUAgCenter.com/BotanicGardens**

4560 Essen Lane  
Baton Rouge, LA 70809

Dear Friends,

It's finally fall! Well, maybe not entirely. Mostly we're still pushing through late summer and the accompanying humidity. We may not feel it yet, but days are getting shorter, humidity is lessening and what passes for fall in the coastal South is here.

Summer is always busy in the LSU AgCenter Botanic Gardens.

- In August one of our signature fundraising events, the Byzantine Icon Workshop, returned. Since this popular workshop began under Ginnie Bolin's guidance in 2013, it has grown from an annual event to a semiannual one, and except for 2020 (COVID-19), it has remained so. Under the leadership of Diana Wells and Kitty Hessburg Wiemer, and with the hands-on assistance of volunteer committee members, instructors and the hospitality team, the workshop serves as a five-day meditational retreat for painting participants, which is especially helpful in today's unusual times. The August workshop portrayed St. Matthew the Apostle. Plans are already in the works for February 2022, when St. Patrick, the patron saint of Ireland, will be the subject portrayed.
- The monthly Reflections in the Garden lectures continued through the summer with reduced audiences enjoying topics on pollinator gardens, our Louisiana State Arboretum, and critical issues around coastal conservation and restoration.
- The popular guided birding walks continued during the last Saturdays in summer and into fall. Those spots fill quickly. Tickets at [www.Eventbrite.com](http://www.Eventbrite.com).

And now the traditional fall activities are well underway.

- October Saturdays are filled with the Corn Maze at Burden as folks enjoy all the outdoor family fun offered. This year continues that tradition with antique tractors, the petting zoo, pumpkin patch and so much more. Tickets are required and are presale only and are available at [www.lsu.edu/botanic-gardens](http://www.lsu.edu/botanic-gardens).
- I'm really looking forward to attending the newly crafted Wine & Roses Rambler to be held on Sunday, Nov. 7. (See details elsewhere in this newsletter.) Chair Janie Braud and her committee have designed a festive, creative brunch in a garden-party style that promises to become yet another signature event of the Botanic Gardens.

Fall is great walking weather. Take a stroll through the Tropical Garden across from the Conference Center. Hike the trails and wander along Mosaic Boardwalk at Black Swamp and through the butterfly meadow. Sign up and join a guided birding hike.

Thank you to the terrific Botanic Gardens staff and the many volunteers who keep the Gardens and the visitor experiences they provide a continual source of enjoyment.

If you would like to only receive this newsletter electronically,  
please email: [friends@burdengardens.com](mailto:friends@burdengardens.com).



# Wine & Roses Rambler

## The New Wine & Roses

By Janie Braud

Wine and Roses has a new name and a new look! Our traditional, elegant sit-down dinner enjoyed by many over the years will now be rambling!

Guests will wind through the gardens and enjoy distinctive food and beverages at four different garden locations. There will be a variety of delicacies — prepared by Bacon and Fig Catering — as you stroll through the oaks, Rose Garden, Pavilion and Orangerie. A signature cocktail, bloody marys, wine, prosecco and beer will be paired

with the various cuisines. The Civic Orchestra of Baton Rouge will play music throughout the gardens.

Additionally, you could be a raffle winner! Len Kilgore, local artist and Friends board member, has generously donated a beautiful 20-inch-by-20-inch custom framed oil painting called “Winter’s Edge Rose.” Raffle tickets are \$10 and can be purchased with your event tickets online or at the door. In the same raffle drawing, you will have a chance to take home one of the beautiful fresh floral centerpieces, each uniquely designed by our talented floral committee. The drawing will take place at 2 p.m. on Nov. 7, but the winner does not need to be present to claim the prize. Winners not present can pick up prizes at the visitor information desk on Monday, Nov. 8.

Another chance to win! Take home a bottle of wine by tossing a ring onto a bottle in the wine toss. Your \$20 ticket gives you four chances to win. Try it! It’s fun! And your contribution will support the new Welcome Center.

Enjoy the beautiful garden setting, great food and drink, raffle, wine toss and live music. Join in the fun at the 2021 Wine & Roses Rambler on Sunday, Nov. 7 from noon to 3 p.m. Tickets for members are \$75 until October 24; tickets for nonmembers are \$85.



Friends  
of LSU AgCenter  
Botanic Gardens  
at Burden



# Wine & Roses Rambler

Sunday, November 7 | Noon-3 p.m.

Refresh your spirit as you wind your way through the gardens. Indulge in gourmet food and drink at a series of tasting stations with live music along the way. Take a chance at a wine toss, a fun floral raffle and a grand prize of an original art piece.

*Music by the Civic Orchestra of Baton Rouge  
Garden Party Attire*

\$85 per person. Tickets available at [tinyurl.com/WRRambler](https://tinyurl.com/WRRambler).  
Raffle and Wine Toss tickets available online and at the door.

Ticket sales are nonrefundable.

LSU AgCenter Botanic Gardens at Burden | 4560 Essen Lane | Baton Rouge | 225-763-3990 | [LSUAgCenter.com/BotanicGardens](https://LSUAgCenter.com/BotanicGardens)

**NIGHT MAZE  
& BONFIRE**

October 30 | 6-9 p.m.  
 LSU AgCenter Botanic Gardens  
*Tickets required. Available at Eventbrite.com*

Serene gardens and towering oaks provide a fitting place for

*A Lasting Tribute*

A donation to the LSU AgCenter Botanic Gardens is appropriate for any occasion. A tribute in the memory of a special person or group, an anniversary, wedding, graduation, birthday, holiday or other event may be celebrated with a gift in the name of the honoree. Honor a loved one with a name or distinctive message on a paver in the Memory Garden, a beautiful iron bench with a plaque, or even dedicate one of our beautiful live oak trees to a loved one.

The LSU AgCenter Botanic Gardens at Burden has recently updated a program designed to honor a special person or group. An anniversary, wedding, graduation, birthday, holiday or any other event may be celebrated with a gift in the name of the honoree. The program offers three options to create a lasting tribute: engraved pavers, iron benches and live oak dedications.

Two paver sizes are available to engrave as an addition to the Memory Garden. You may also choose a beautiful live oak on the property to dedicate. A bronze plaque will be placed at the base of the tree with your special message. The program most recently incorporated beautiful iron benches with a plaque for your special message into the Lasting Tribute options.





# GREEN STICK WORKSHOP

## Summertime in the Kitchen with the LSU AgCenter FOODii

The Green Stick Workshop is a quarterly workshop designed to offer home gardeners hands-on learning about all things green. This summer, the LSU AgCenter Botanic Gardens brought gardeners into the kitchen with the help of the LSU AgCenter Food Innovation Institute, known as FOODii.

Sixteen guests of all ages learned a few new skills from FOODii Director Gaye Sandoz and chef Jason Gilfour at the Summertime in the Kitchen Green Stick Workshop. The class learned how to make a peach custard ice cream and a refreshing summer salad with creamy yogurt dressing. After a morning of dicing and slicing, all the workshop guests enjoyed their creations together.

The LSU AgCenter Botanic Gardens looks forward to a holiday-themed Green Stick Workshop in November 2021.



*FOODii staff helps younger guests add salad dressing ingredients to a jar.*



*Chef Jason Gilfour demonstrates the proper way to hold garlic when cutting.*



*Attendees chop lettuce for their summer salad.*



*Judy Foil (left) and Simone Kramer (right) prepare to slice green onions.*





INVITING, TIMELESS AND UNOBTRUSIVE

Welcome Center *continued from page 1*

all landscapes are visible through the numerous covered areas. The inward-sloped roof will also serve as water feature with rainwater flowing into the central rain garden. The rain garden represents green infrastructure that mirrors the function of our wetlands serving as a sink for stormwater and provides visitors with an immersive learning experience.

The Welcome Center will include numerous program elements to enhance the visitor experience. The entry area will be visible as you drive to the tree-lined permeable surface parking area. Walking from the parking area you will



LOUISIANA WATER GARDEN

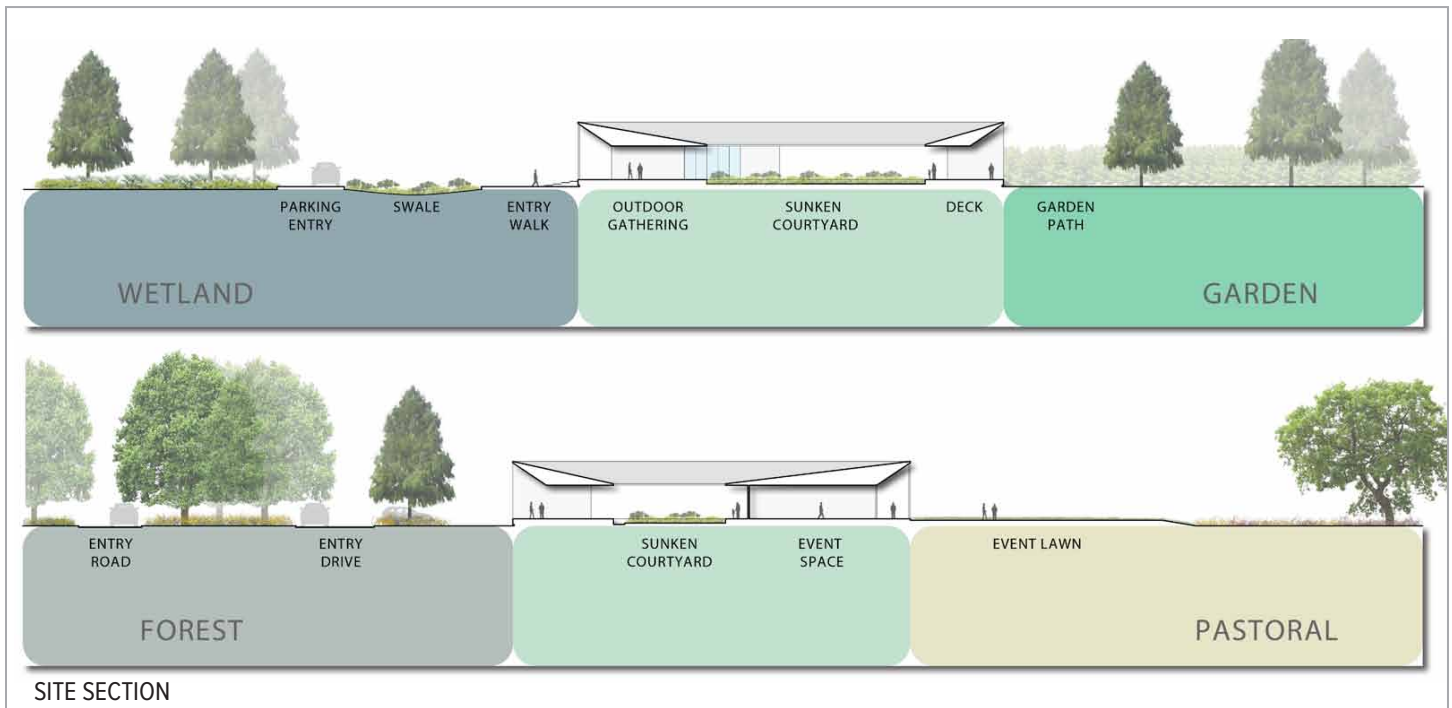

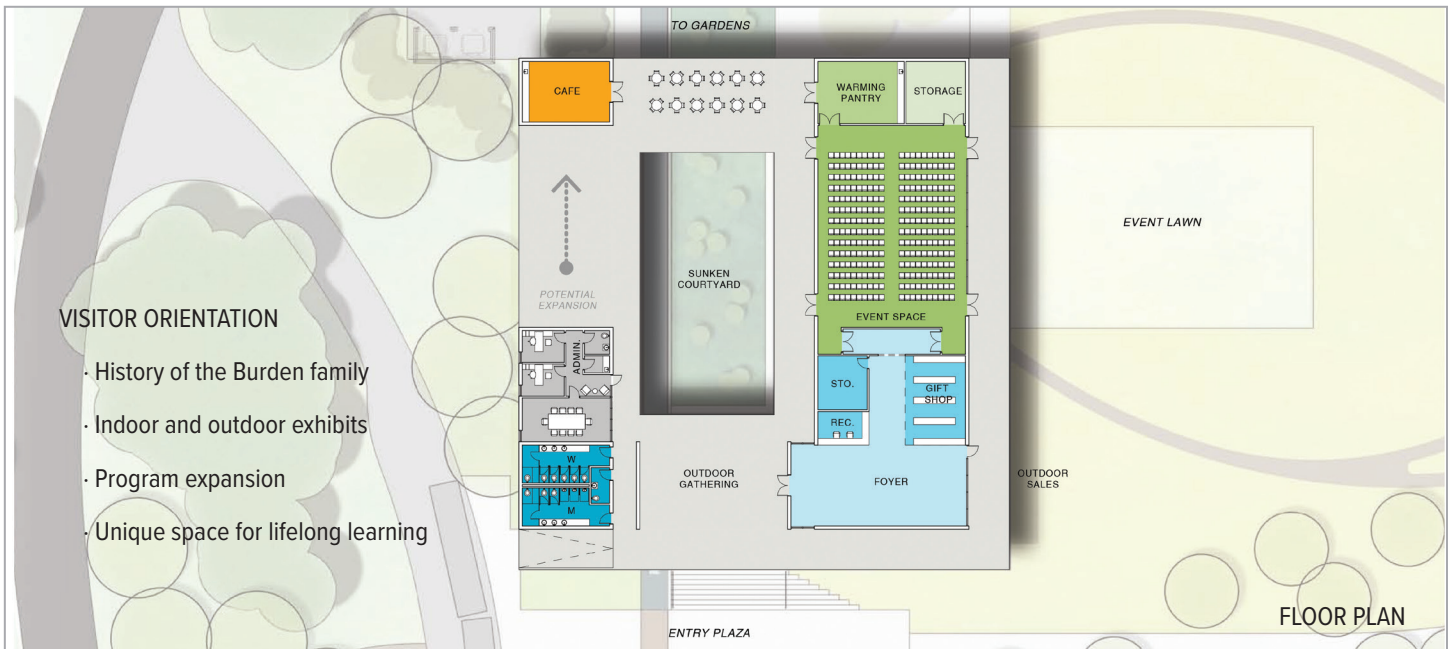

**VISITOR ORIENTATION**

- History of the Burden family
- Indoor and outdoor exhibits
- Program expansion
- Unique space for lifelong learning

cross bioswales that will assist with water retention and percolation. The Welcome Center will sit approximately 2 feet off the ground on a pier system with steps and a ramp bringing you to an inviting outdoor covered entry area for visitor orientation. This space will include an interactive map of the property, space for exhibits and views to the surrounding landscapes. From this area you will be able to view the central rain garden and access the restrooms, offices of the event coordinator and communications coordinator, and the Charlie and Carol Lamar Reception Area for orientation and tickets as well as the gift shop. The gift shop will provide visitors with the opportunity to purchase plants and plant-related items that are unique to Burden. The reception area will also provide space for interior exhibits,

and it will serve as the primary entry to the event center. The event center will accommodate 300-seated auditorium style and capacity for 250 seated at tables. The north wall of this room will open to the event lawn, which will double the capacity and allow for over 600 people to enjoy the indoor/outdoor space. The café will be located at the west end of the Welcome Center and will include an outdoor dining area overlooking the rain garden, orchid house and formal landscape. This area will also serve for outdoor educational programming, such as workshops and cooking demonstrations.

A beautifully landscaped entrance and surrounding landscape, designed by CARBO Landscape Architecture, will provide new visitors and returning friends an escape to nature. The Louisiana-themed landscapes surrounding the



VISION, MISSION AND WAYFINDING



Welcome Center will tell the story of how water has been and will continue to be the common theme of how we have lived in those landscapes throughout history and how we continue to be resilient by understanding the changing environment

and combining that with the use of green infrastructure. To find out more about the Welcome Center and how you might help make it become reality, please contact Jenny Jackson at 225-763-3990.





# Campus Connections



*Natalie Boston*

## Natalie Boston

I'm a senior at LSU, and I am excited to be working at the LSU AgCenter Botanic Gardens! I am eager to learn how to coordinate weddings and events. I love nature, and I'm very excited to work with a team that wants to bring so much beauty to Baton Rouge.

## Kyla Bryant, arborist intern

I had an amazing experience working at Burden Museum & Gardens. I had the opportunity to work with a great arborist team who taught me so many interesting things. My focal point of this internship, besides enhancing my knowledge, is measuring the circumference, diameter and condition of the live oaks. This will give us a value of how much carbon dioxide is sequestered, air pollution is fixed and water runoff is decreased. Each unit has money value associated with it. We will be able to see each tree individually and together. Along with that I have also helped with vine and sucker removal, spraying trees, raising canopies, tree removal, equipment operation, forestry mowing and trail building and maintenance.



*Kyla Bryant*

## Maeve Dumond

I'm a fifth-year senior in the School of Architecture at LSU with a passion for community design and development. The LSU AgCenter Botanic Gardens at Burden has given me an opportunity to explore so many aspects of design and connect with amazing people. I'm lucky to be able to work at one of the prettiest places in Baton Rouge and collaborate with a group of people who push me to be a better designer and person!



*Maeve Dumond*



*Lindsey Oxford*

## Lindsey Oxford

This summer I got to work with Keith Lewis, who is an All-America Selections judge at the LSU AgCenter Botanic Gardens. Every week we visited the field to harvest vegetables, take notes, make comparisons between the trials and established varieties and score the test varieties. We even held a tomato taste test at the Rural Life Museum to determine if the test varieties are more desirable than their comparisons. It was interesting to see that the test varieties that won the taste test also outperformed their comparisons in the field.

I can't wait for the AAS winners to be announced later this year and stock up on some great varieties for my next summer garden.



*Emma Peneguy*

## Emma Peneguy

Meet Emma Peneguy, a senior at LSU studying mass communication with a minor in political science. "I'm so excited to join the LSU AgCenter Botanic Gardens at Burden family! I know I'm going to enjoy my time here," Peneguy said.

In the future, Emma hopes to continue working in communications with nonprofit organizations. In her free time, she enjoys spending time with friends and family, playing volleyball and watching entirely too much HGTV.



*Eden Regan*

## Eden Regan

I'm an LSU junior from Jean Lafitte, and I am studying natural resource ecology and management. This summer I assisted Ken Owens with basic landscaping, like spaying herbicide, pulling vines and maintaining the property's bird feeders. I worked with our LSU AgCenter Botanic Garden database, IrisBG, and helped finish adding the accessions of the Windrush camellia collection into the database. For my intern project I evaluated vine overgrowth on the property, and to gain some helping hands I organized a service event for LSU students to come out to the garden and help pull some of the overgrowth.

## What's Happening at Burden



Above: Burden landscape team paused their hard work for a group photo.  
Left: Poinsettias being potted for the 2021 Poinsettia Sale.  
Below: The Burden landscape staff planted a brand new Orangerie lawn in August.



# The Perfect Place



Plan your wedding or special event at a lush garden oasis in the heart of Baton Rouge. The LSU AgCenter Botanic Gardens offers several unique venues for the perfect day or evening event. Formal and informal gardens provide a beautiful setting for a lifetime of memories.



LSU AgCenter Botanic Gardens

Contact us for rental facility information  
4560 Essen Lane . 225-763-3990 . [LSUAgCenter.com/BotanicGardens](http://LSUAgCenter.com/BotanicGardens) . Baton Rouge



LSU AgCenter Botanic Gardens  
 128 Knapp Hall  
 Baton Rouge, LA 70803

PHYSICAL LOCATION: 4560 Essen Lane, Baton Rouge, La. 70809 | 225-763-3990 | [LSUAgCenter.com/BotanicGardens](http://LSUAgCenter.com/BotanicGardens)

<b>October 2021</b>			
Oct. 2, 9, 16, 23 & 30	10 a.m.-5 p.m.	Corn Maze at Burden	Corn Maze, farm animals, pumpkin and face painting, corn crib, children's zip line, giant sling shots, hay mountain and hay rides; \$15, free for children 2 and under. Tickets available at <a href="http://www.eventbrite.com">www.eventbrite.com</a> .
Oct. 2	10 a.m.-1 p.m.	StoryTime in the Garden	Storybook reading and imagination-themed activities at Corn Maze; ages 3-8.
Oct. 2	8 a.m.-5 p.m.	Rural Life Museum: Harvest Days	Living history demonstrations will interpret activities that took place on Louisiana farms during harvest time in the 19th century.
Oct. 4	Noon-1 p.m.	Reflections in the Garden	Reflections in the Garden: "Master Plan for Burden Museum & Gardens: Envisioning the Future," Suzanne Turner and Associates. Members free, nonmembers \$10.
Oct. 5	6 p.m.	East Baton Rouge Master Gardener Association	Monthly meeting.
Oct. 23	3:30-6 p.m.	Rural Life Museum: Zapp's International Beerfest	More than 200 foreign, domestic and home-brewed beer and ales will be available for tasting. For patrons 21 and up only. Tickets available at <a href="http://www.bontempstix.com">www.bontempstix.com</a> .
Oct. 30	6-9 p.m.	Night Maze	Corn Maze, farm animals, corn crib and hay mountain. Evening bonfire with s'mores and music. \$15. Free for children 2 and under. Tickets available at <a href="http://www.eventbrite.com">www.eventbrite.com</a> .
Oct. 31	3-6 p.m.	Rural Life Museum: Haints, Haunts and Halloween	Storytelling, cake walks, old-fashioned games and trick-or-treating. \$5.
<b>November 2021</b>			
Nov. 1	Noon-1 p.m.	Reflections in the Garden	Topic: "Fantastical Poinsettias." Elena Fennell, co-owner of Clegg's Nursery, and Wanda Ellis, research associate, LSU AgCenter Botanic Gardens. Members free, nonmembers \$10.
Nov. 2	12:30 p.m.	East Baton Rouge Master Gardener Association	Monthly meeting
Nov. 6	9 a.m.-Noon	StoryTime in the Garden	Storybook reading and imagination-themed activities; ages 3 - 8. Free.
Nov. 7	Noon-3 p.m.	Wine & Roses Rambler	A progressive version of the traditional sit-down dinner will wind you through the garden as you enjoy a series of tasting stations with live music; a wine toss; a fun, floral raffle; and a grand prize of an original art piece.
Nov. 25	Closed	Burden Museum & Gardens Holidays	Burden Museum & Gardens is closed Thanksgiving Day.
Nov. 27	8 a.m.-2 p.m.	Annual Poinsettia Show and Sale	It's not Christmas in Louisiana without Burden poinsettias! Over 50 varieties of poinsettia will be on display and available for sale at the Botanic Gardens greenhouses.
<b>December 2021</b>			
Dec. 5	10 a.m.-5:30 p.m.	Rural Life Museum: A Rural Life Christmas	A 19th-century Louisiana celebration with musical groups, demonstrating artisans, storytellers, costumed reenactors and Papa Noel. \$10. Free for children 10 and under.
Dec. 6	Noon-1 p.m.	Reflections in the Garden	Topic: "Creating Herbal Holiday Gifts," Cynthia Nobles, LSU Press cookbook editor, and Melinda Winans, teacher and founding member of Herb Society of America, Baton Rouge unit. Members free, nonmembers \$10.
Dec. 11	9 a.m.-Noon	StoryTime in the Garden	Storybook reading and imagination-themed activities; ages 3 - 8. Free.
Dec. 24, 25; Jan. 1	Closed	Burden Museum & Gardens Holidays	Burden Museum & Gardens is closed Christmas Eve, Christmas Day and New Years Day.

Visit our website: [www.LSUAgCenter.com/BotanicGardens](http://www.LSUAgCenter.com/BotanicGardens)

PUB 3672-21-Fa 425 9/21

The LSU AgCenter and LSU provide equal opportunities in programs and employment.